

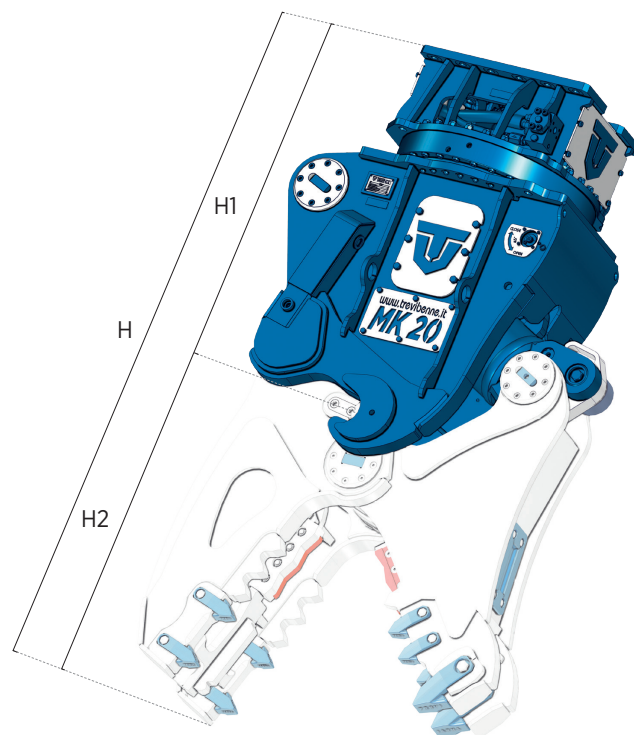

# MK SERIES

## MULTI KIT PULVERIZER

- FRANTUMATORE MULTI KIT
- BROYEUR MULTI KIT
- DEMOLEDOR MULTI KIT
- MULTIPROZESSOREN

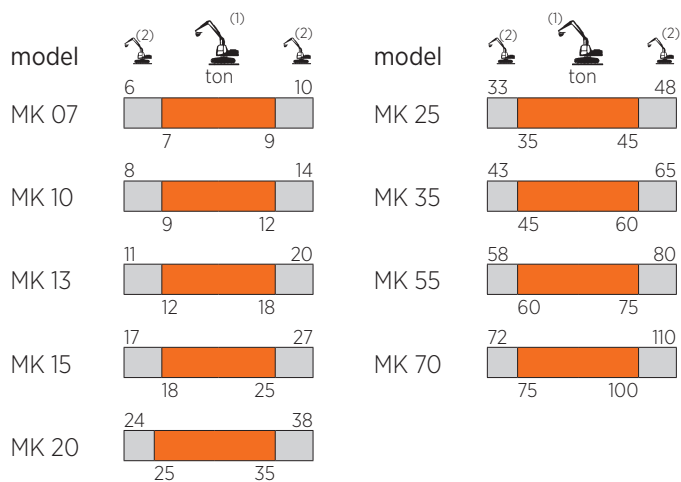

- (1) Optimum excavator-equipment combination  
Accoppiamento escavatore-attrezzatura ottimale  
Couplage pelle-équipement optimal  
Acoplamiento excavadora-implimento optimal  
Optimale Bagger-Ausrüstung Kombination
- (2) Possible excavator-equipment combination  
Accoppiamento escavatore-attrezzatura possibile  
Couplage pelle-équipement possible  
Acoplamiento excavadora-implimento posible  
Mögliche Bagger-Ausrüstung Kombination



		MK 07 *	MK 10 *	MK 13 *	MK 15	MK 20	MK 25	MK 35	MK 55	MK 70
	kg.	410	570	795	1205	1490	1970	2150	3550	5020
HI**	mm.	810	1000	1055	1220	1330	1370	1375	1580	1720
	bar	320	320	350	350	350	350	350	350	350
	l/min.	80 / 150	150 / 250	180 / 250	180 / 250	200 / 300	250 / 350	300 / 400	400 / 500	450 / 600
	bar	140	140	140	140	140	140	140	140	140
	l/min.	10	10	10	10 / 20	10 / 20	10 / 20	10 / 20	30 / 60	30 / 60
		/	/	/	/	/	/	/	√	√

\* Mechanical version / \* Versione meccanica / \* Version mécanique / \* Versión mecánica / \* Mechanischer Version  
\*\* H = HI + H2

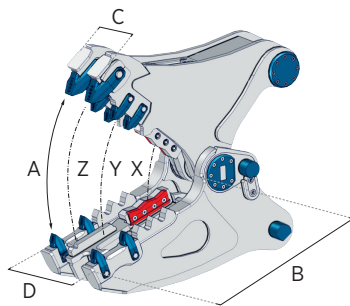
**KIT FR**

		MK 07	MK 10	MK 13	MK 15	MK 20	MK 25	MK 35	MK 55	MK 70
	kg.	250	410	635	680	1035	1270	1720	3200	3940
A	mm.	530	660	720	740	880	905	970	1190	1300
B	mm.	510	610	630	660	790	820	860	1060	1130
C	mm.	175	195	235	300	310	360	390	500	500
D	mm.	305	355	390	465	485	570	640	680	770
	mm.	140	140	180	220	260	260	260	260	325
H2**	mm.	660	760	870	890	1045	1100	1210	1410	1580
X	t.	95	121	151	229	248	350	398	495	590
Y	t.	51	66	78	121	151	163	182	242	315
Z	t.	37	44	61	78	97	127	139	155	210
∅ max	mm.	20	25	30	35	40	45	50	60	75
	IPN max	mm.	/	/	/	/	/	/	/	/
	HEA max	mm.	/	/	/	/	/	/	/	/
	max	mm.	/	/	/	/	/	/	/	/

**KIT CS**

		MK 07	MK 10	MK 13	MK 15	MK 20	MK 25	MK 35	MK 55	MK 70
	kg.	210	360	580	630	950	1240	1425	2440	2850
A	mm.	250	320	400	420	480	500	525	580	700
B	mm.	325	390	450	485	525	560	565	660	755
C	mm.	65	75	80	100	120	130	130	135	165
D	mm.	250	300	300	330	380	435	435	500	550
	mm.	310	370	410	470	510	565	565	660	755
H2**	mm.	545	630	725	775	890	935	990	1150	1300
X	t.	220	274	374	507	622	869	893	1020	1210
Y	t.	88	110	145	187	284	350	380	440	515
Z	t.	51	66	90	102	151	175	193	231	265
∅ max	mm.	30	35	40	50	60	65	70	90	110
	IPN max	mm.	80	120	140	210	360	380	400	600
	HEA max	mm.	/	100	120	140	230	250	300	400
	max	mm.	/	/	/	/	/	/	/	/

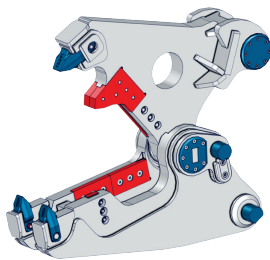
**KIT CB**

		MK 07	MK 10	MK 13	MK 15	MK 20	MK 25	MK 35	MK 55	MK 70
	kg.	*	450	585	720	1090	1305	1780	*	3890
A	mm.	*	580	640	740	810	850	910	*	1160
B	mm.	*	560	700	720	800	815	875	*	1180
C	mm.	*	100	100	110	130	130	130	*	185
D	mm.	*	290	310	320	350	410	410	*	610
	mm.	*	350	400	420	480	500	500	*	640
H2**	mm.	*	800	920	1000	1125	1155	1255	*	1640
X	t.	*	241	326	507	615	845	893	*	1110
Y	t.	*	66	78	121	151	187	211	*	320
Z	t.	*	44	60	78	97	121	139	*	205
∅ max	mm.	*	30	35	40	45	50	55	*	85
	IPN max	mm.	/	/	/	/	/	/	/	/
	HEA max	mm.	/	/	/	/	/	/	/	/
	max	mm.	/	/	/	/	/	/	/	/

\* Available on request / \* Disponibile su richiesta / \* Disponible sur demande / \* Disponible a petición / \* Verfügar auf Anfrage



# MK SERIES

## MULTI KIT PULVERIZER

- FRANTUMATORE MULTI KIT
- BROYEUR MULTI KIT
- DEMOLEDOR MULTI KIT
- MULTIPROZESSOREN

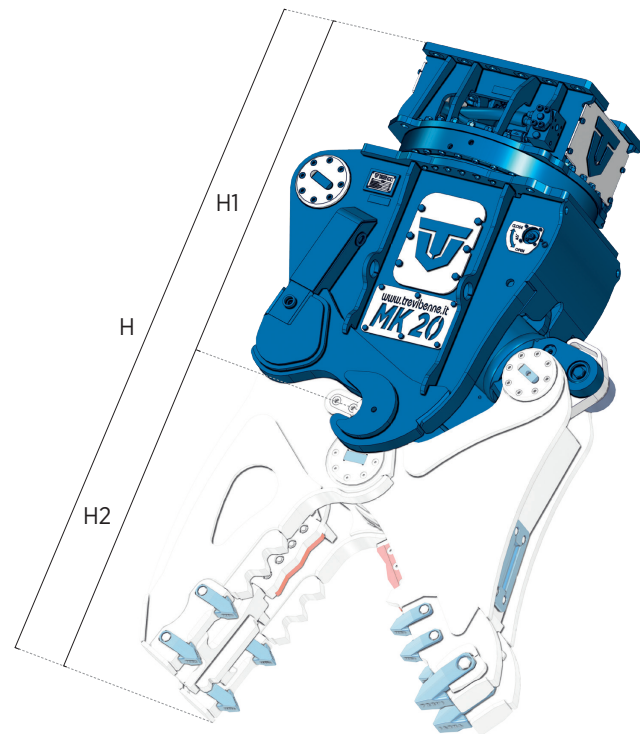
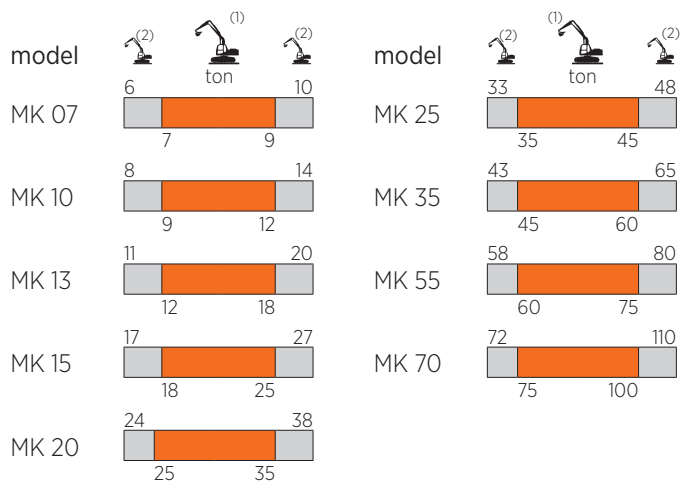

- (1) Optimum excavator-equipment combination**  
 Accoppiamento escavatore-attrezzatura ottimale  
 Couplage pelle-équipement optimal  
 Acoplamiento excavadora-implemento optimal  
 Optimale Bagger-Ausrüstung Kombination
- (2) Possible excavator-equipment combination**  
 Accoppiamento escavatore-attrezzatura possibile  
 Couplage pelle-équipement possible  
 Acoplamiento excavadora-implemento posible  
 Mögliche Bagger-Ausrüstung Kombination



**HARDOX®**  
WEAR PLATE



**HARDOX®**  
IN MY BODY



		MK 07 *	MK 10 *	MK 13 *	MK 15	MK 20	MK 25	MK 35	MK 55	MK 70
	kg.	410	570	795	1205	1490	1970	2150	3550	5020
	mm.	810	1000	1055	1220	1330	1370	1375	1580	1720
	bar	320	320	350	350	350	350	350	350	350
	l/min.	80 / 150	150 / 250	180 / 250	180 / 250	200 / 300	250 / 350	300 / 400	400 / 500	450 / 600
	bar	140	140	140	140	140	140	140	140	140
	l/min.	10	10	10	10 / 20	10 / 20	10 / 20	10 / 20	30 / 60	30 / 60
		/	/	/	/	/	/	/	√	√

\* Mechanical version / \* Versione meccanica / \* Version mécanique / \* Versión mecánica / \* Mechanischer Version  
 \*\* H = H1 + H2

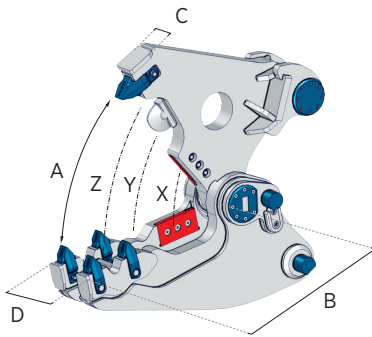
**KIT HC**

		MK 07	MK 10	MK 13	MK 15	MK 20	MK 25	MK 35	MK 55	MK 70
	kg.	250	435	575	680	1075	1235	1700	2870	*
A	mm.	525	600	740	835	920	945	1010	1180	*
B	mm.	490	610	710	740	765	815	875	1060	*
C	mm.	90	100	100	110	130	130	130	200	*
D	mm.	240	300	300	340	350	400	450	600	*
	mm.	125	150	200	175	240	250	250	290	*
H2**	mm.	690	810	925	1005	1125	1170	1275	1410	*
X	t.	125	148	199	265	342	422	464	530	*
Y	t.	56	66	90	109	132	182	217	242	*
Z	t.	37	44	60	78	102	127	139	154	*
∅ max	mm.	20	25	30	35	40	45	50	60	*
	IPN max	mm.	/	/	/	/	/	/	/	/
	HEA max	mm.	/	/	/	/	/	/	/	/
	max	mm.	/	/	/	/	/	/	/	/

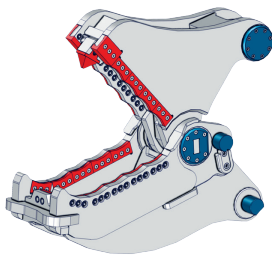
**KIT CH**

		MK 07	MK 10	MK 13	MK 15	MK 20	MK 25	MK 35	MK 55	MK 70
	kg.	225	380	610	740	1000	1300	1590	*	*
A	mm.	310	390	445	500	635	550	720	*	*
B	mm.	420	470	580	615	750	785	960	*	*
C	mm.	160	185	235	275	295	350	350	*	*
D	mm.	275	320	335	395	415	475	475	*	*
	mm.	340	400	530	530	660	600	750	*	*
H2**	mm.	650	755	900	910	1080	1100	1280	*	*
X	t.	144	160	296	314	452	869	893	*	*
Y	t.	81	95	126	139	182	260	265	*	*
Z	t.	51	55	73	97	121	157	163	*	*
∅ max	mm.	30	35	40	45	50	55	60	*	*
	IPN max	mm.	/	/	/	/	/	/	/	/
	HEA max	mm.	/	/	/	/	/	/	/	/
	max	mm.	/	/	/	/	/	/	/	/

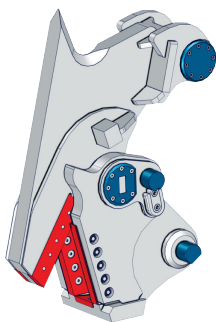
**KIT CL**

		MK 07	MK 10	MK 13	MK 15	MK 20	MK 25	MK 35	MK 55	MK 70
	kg.	*	*	*	560	1000	1400	1750	*	*
A	mm.	*	*	*	270	350	370	400	*	*
B	mm.	*	*	*	360	465	520	580	*	*
C	mm.	*	*	*	115	145	150	160	*	*
D	mm.	*	*	*	310	390	440	480	*	*
	mm.	*	*	*	320	400	430	500	*	*
H2**	mm.	*	*	*	505	630	695	750	*	*
X	t.	*	*	*	265	326	386	422	*	*
Y	t.	*	*	*	182	241	272	277	*	*
Z	t.	/	/	/	133	169	193	205	*	*
∅ max	mm.	/	/	/	/	/	/	/	/	/
	IPN max	mm.	/	/	/	/	/	/	/	/
	HEA max	mm.	/	/	/	/	/	/	/	/
	max	mm.	*	*	10	12	14	16	*	*

\* Available on request / \* Disponibile su richiesta / \* Disponible sur demande / \* Disponible a petición / \* Verfügar auf Anfrage