



Diamond Tools and Equipment

Product Catalog

icsdiamondtools.com



Diamond Tools and Equipment

Who is ICS?

ICS® is committed to helping professionals get their job done right. We have been producing innovative, professional-quality concrete and pipe cutting solutions for over 25 years. Our diamond chains are designed and built in Portland, Oregon USA, using only the best global materials. Patented SealPro® and SealPro Advanced anti-stretch technology significantly reduces chain stretch so your chain lasts longer and you spend less time tensioning. Our patented PowerGrit® pipe cutting chain allows users to cut ductile iron, HDPE and PVC pipe in a confined space with no fear of rotational kickback.

Our patented diamond chain, combined with best-in-class guidebars and powerheads give you a cutting system that can plunge cut up to 63cm deep, create precise openings of all shapes and sizes, cut tight radiuses and clean, square corners with no overcutting. We know the challenges you face every day and understand in the importance of investing in the right tools. ICS technology delivers the perfect blend of power, precision and reliability that allows you to get your job done quickly and safely compared to other cutting methods.

Headquartered in Portland, Oregon, ICS also has a sales and distribution office in Belgium and a worldwide sales and service network covering more than 70 countries. ICS concrete power cutters, diamond chains, and related products are sold and supported by a network of ICS Authorized Dealers and backed by a comprehensive network of factory-trained personnel and service centers



Table of Contents

ICS Power Cutters

ICS Petrol Power Cutters.....6-9

ICS Hydraulic Power Cutters..... 10-13

ICS Pneumatic Power Cutters..... 14-15

ICS Diamond Tools & Accessories

ICS Diamond Chains..... 16-17

Accessories.....18-19

FAQ's

FAQ's.....20-21

icsdiamondtools.com
+32 10 301 251

SealPRO® Technology

There are many jobs that only a power cutter can do. And for those jobs, only ICS includes patented SealPRO and SealPRO Advanced anti-stretch technology, which locks out the abrasive slurry created when cutting concrete, stone, or masonry, reducing chain stretch and increasing the useful life of the chain.

Concrete cutting pros like you depend on your tools. All day, every day. Under the toughest conditions. The precision and versatility you've come to expect from ICS in addition to the perfect blend of power and efficiency. Diamond segments laser-welded to a steel chassis grind through concrete, stone and masonry, eliminating kickback and the damage that percussive methods can cause. This remarkable property allows ICS power cutters to plunge cut up to 63cm into the hardest concrete or make perfectly square corners with no overcuts. We know the challenges you face and understand the importance of investing in the right tools.

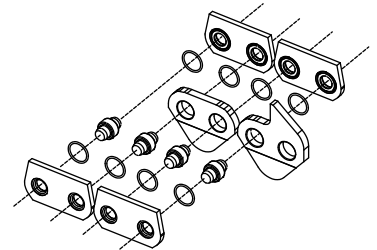

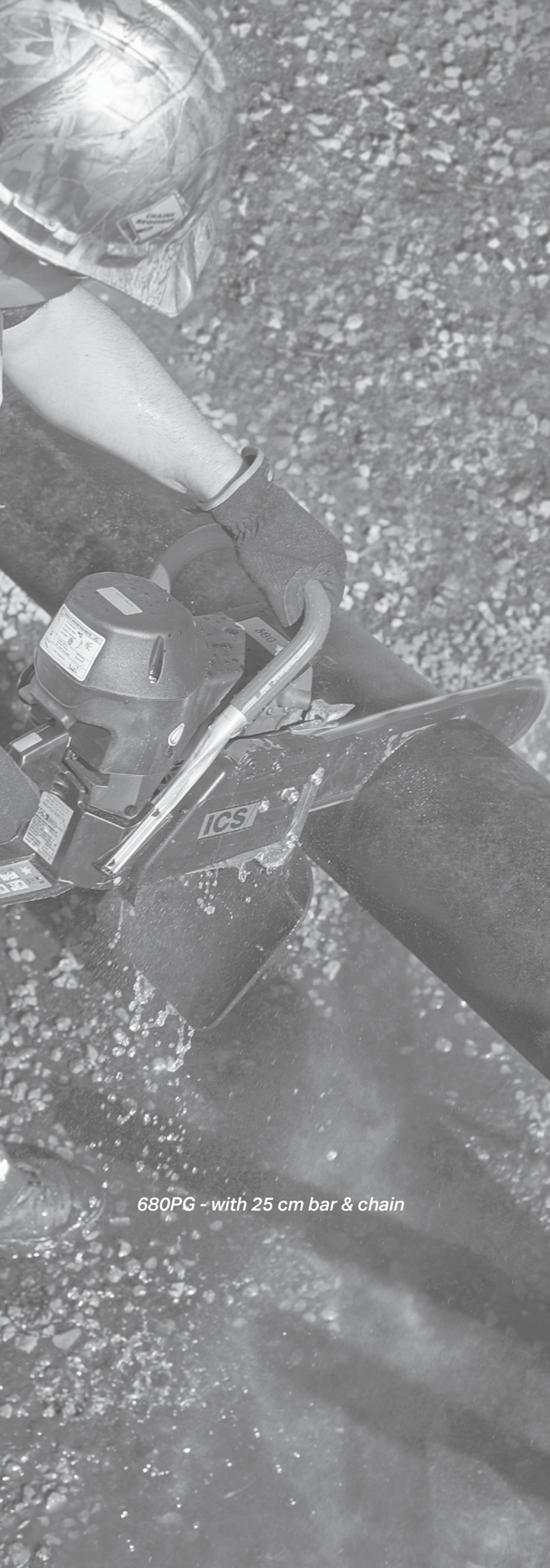

680PG - with 25 cm bar & chain

Petrol Power

680ES

Built to meet the operation and flexibility demands of the general construction user, the 680ES stands alone in terms of reliability and value. Easy to start with a new multifunction lever to control choke, run, and stop functions. The distinctive black powerhead houses specially designed carburetion and ignition systems that work together to ensure easy starting, cooler operation and dependable performance at just about any elevation. Available with 30 cm and 35 cm guidebars and the entire line of FORCE3™ series diamond chain. With a quick switch of the guidebar, chain and drive sprocket, the new 680ES can operate PowerGrit Utility Cutter chain 25 cm cutting depth, designed to cut ductile iron pipe.

680ES



680PG



680ES TECHNICAL SPECIFICATIONS

Max Cutting Depth	35 cm
Bar length	25cm PowerGrit chain only 30cm, 35cm FORCE3 chain
Engine Speed	11500 +/- 500 rpm (max)
Idling Speed	2800-3200 rpm
Horsepower	3.7kW
Engine Type	2-stroke, single cylinder, air cooled
Displacement	76.5cc
Powerhead Dimensions	46 cm x 29 cm x 25 cm
Guaranteed Sound Power Level, Lwa (1)	117 dB(A); (Kwa = 3.0 dB(A))
Sound Pressure Level, at Operator's Ear Lwa (1)	101.0 dB(A); (K = 2.0 dB(A))
Vibration, a _{hv} , eq Concrete Cutting (2)	7.2 m/s ² (K=1.0 m/s ²) Front Handle 8.5 m/s ² (K=1.0 m/s ²) Rear Handle
Water Supply Requirement	Minimum of 1.4 bar (20 psi)
Water Flow Requirement	Minimum: 8 lpm (2 gpm)
Fuel Mix Ratio	2% (50:1) fuel-to-oil
Fuel Capacity	0.88 liter

(1) Measured in accordance with ANSI S12.51-2012/ISO3741:2010

(2) Measured in accordance with ISO5349-1:2001 and ISO22867:2011

For Cutting Concrete & Pipe

680ES-GC PETROL POWER CUTTERS AND CONSUMABLES

PART NUMBER	DESCRIPTION
576155	ICS 680ES Powerhead
584291	ICS 680ES GC-12 Petrol Saw Package, with 30 cm Guidebar & FORCE3 Chain
584293	ICS 680ES GC-14 Petrol Saw Package, with 35 cm Guidebar & FORCE3 Chain
584290	ICS FORCE3-29, 30 cm chain
584297	ICS FORCE-29 Brick 30 cm chain
584298	ICS FORCE3-29 Premium 30 cm chain
71395	ICS 680GC Guidebar 30 cm/29 segments
584292	ICS FORCE3-32, 35 cm chain
584299	ICS FORCE3-32, 35 cm Brick chain
584302	ICS FORCE3-32, 35 cm Premium chain
513122	ICS 680GC Guidebar 35 cm/32 segments
70949	ICS 680GC Drive Sprocket
73935	ICS 680ES Premium Tensioner Kit

Guidebars, chains and drive sprockets fit 613GC

Did you know...

Your 680ES can be converted to cut ductile iron, cast iron, PVC and more? Just replace the guidebar, chain and drive sprocket and you are all ready to go!

680ES-PG PETROL POWER CUTTERS AND CONSUMABLES

PART NUMBER	DESCRIPTION
580423	ICS 680ES PG-10 Petrol Saw Package with 25 cm FORCE4 guidebar, PowerGrit-25 chain
580424	ICS PowerGrit-25, 25 cm Chain
579158	ICS 680PG Guidebar 25 cm/25 segments
525496	ICS 680ES PowerGrit Drive Sprocket
73935	ICS 680ES Premium Tensioner Kit

Guidebars, chains and drive sprockets fit 613GC

680ES - with 35cm bar & chain





695XL F4- with 40cm bar & chain

Petrol Power

695XL

The 695XL features include an easy to start engine with higher energy ignition system and durable, long-lasting components including a new muffler, carburetor and piston & cylinder. Available with 30 cm, 35 cm & 40cm guidebars and the entire line of FORCE3™, FORCE4® and PowerGrit® series diamond chains. Based on the best-selling 695 power cutter platform, the 695XL is the highest horsepower ICS petrol power cutter for frequent-use by general construction, utility contractors and concrete professionals.



695XL TECHNICAL SPECIFICATIONS

Max Cutting Depth	40cm
Bar length	up to 40cm
Engine Speed	9300 +/- 150 rpm (max)
Idling Speed	2700 +/- 100 rpm
Horsepower	4.8kW (6.4 hp) @ 9000 rpm
Engine Type	2-stroke, single cylinder, air cooled
Displacement	94 cc
Powerhead Dimensions	46 cm x 36 cm x 30 cm
Guaranteed Sound Power Level, Lwa (1)	115 dB(A); (Kwa = 1.0 dB(A))
Sound Pressure Level, at Operator's Ear Lwa (1)	104.6 dB(A); (K = 1.0 dB(A))
Vibration, a hv, eq Concrete Cutting (2)	3.6 m/s ² (K=0.2 m/s ²) Front Handle 3.1 m/s ² (K=0.2 m/s ²) Rear Handle
Vibration, a hv, eq Pipe Cutting (2)	5.62 m/s ² (K=0.2 m/s ²) Front Handle 5.28 m/s ² (K=0.2 m/s ²) Rear Handle
Water Supply Requirement	Minimum of 1.4bar (20 psi)
Water Flow Requirement	Minimum: 8 lpm
Fuel Mix Ratio	(2%) 50:1 fuel-to-oil
Fuel Capacity	1.0 liter

(1) Measured in accordance with ANSI S12.51-2012/ISO3741:2010

(2) Measured in accordance with ISO5349-1:2001, ISO22867:2011 and ISO19432:2012

For Cutting Concrete & Pipe

695XL-GC PETROL POWER CUTTERS AND CONSUMABLES

PART NUMBER	DESCRIPTION
575862	ICS 695XL GC Powerhead
584296	ICS 695XL GC-14 Petrol Saw Package, with 35 cm Guidebar & FORCE3-32 Chain
584300	ICS 695XL GC-16 Petrol Saw Package, with 40 cm Guidebar & FORCE3-35 Chain
584292	ICS FORCE3-32, 35 cm chain
584299	ICS FORCE3-32 Brick, 35 cm chain
584302	ICS FORCE3-32 Premium, 35 cm chain
73600	ICS 695GC Guidebar 35 cm/32 segments
584294	ICS FORCE3-35, 40 cm chain
584301	ICS FORCE3-35 Brick, 40 cm chain
584303	ICS FORCE3-35 Premium, 40 cm chain
71600	ICS 695GC Guidebar 40 cm/35 segments
70949	ICS 695GC Drive Sprocket
543904	ICS 695XL-GC Premium Tensioner Kit

Guidebars, chains and drive sprockets fit 633GC

695XL-F4/695XL-PG PETROL POWER CUTTERS AND CONSUMABLES

PART NUMBER	DESCRIPTION
575826	ICS 695XL F4 Powerhead
576151	ICS 695XL F4-12 Petrol Saw Package, with 30 cm FORCE4 Guidebar & ProFORCE-25 Chain
575872	ICS 695XL F4-16 Petrol Saw Package, with 40 cm FORCE4 Guidebar & ProFORCE-29 Chain
575827	ICS 695XL PG-16 Petrol Saw Package with 40 cm guidebar, PowerGrit-29 chain
531743	ICS ProFORCE-25, 30 cm chain
531745	ICS ProFORCE-25 Premium L 30 cm chain
531739	ICS ProFORCE-25 Premium S 30 cm chain
531747	ICS ProFORCE-25 Abrasive 30 cm chain
553208	ICS 695F4 Guidebar 30 cm/25 segments
525342	ICS ProFORCE-29, 40 cm chain
525343	ICS ProFORCE-29 Premium L 40 cm chain
531735	ICS ProFORCE-29 Premium S 40 cm chain
525344	ICS ProFORCE-29 Abrasive 40 cm chain
524490	ICS 695F4 Guidebar 40 cm/29 segments
537764	ICS PowerGrit-29, 40 cm Chain
524490	ICS 695F4 Guidebar 40 cm
525496	ICS 695F4 Drive Sprocket
543904	ICS 695XL - F4/PG Premium Tensioner Kit

Guidebars, chains and drive sprockets fit 633F4



695XL PG - with 40cm bar & chain

Hydraulic Power

890 Series

The ICS 890 Series hydraulic cutting system offers the superior strength of FORCE4® technology. From the redesigned, more durable rear handle, to the easy to replace drive sprocket, this hydraulic power cutter is engineered to stand up to your toughest jobs. In a package that exceeds industry standards this sleek powerhouse is packed with features designed to make it work as hard as you do.



890F4



890F4-FL



890PG

890 F4- with 63 cm bar & chain

890F4/PG TECHNICAL SPECIFICATIONS

	30 LPM	45 LPM
Weight	12.4 kg with 38 cm bar and chain	
Bar Length	Up to 63 cm	
Motor Speed	6100 rpm	6500 rpm
Powerhead Dimensions	58.5 cm Length 26.5 cm Height 24 cm Width	
Torque	13.8 Nm	19.2 Nm
Horsepower	8.5 kW	13 kW
Hydraulic Supply	30 lpm (172.5 bar)	45 lpm (172.5 bar)
Noise Level	107 dB @ 1 m	
Water Supply	Minimum 1.5 bar	

* product data shown is rated based on maximum input conditions and efficiency assumptions may vary dependent on power supply.

For Cutting Concrete & Pipe

890F4 HYDRAULIC POWER CUTTERS AND CONSUMABLES

PART NUMBER	DESCRIPTION
566357	ICS 890F4 Powerhead 30 l/m, 30 cm hose whips
566356	ICS 890F4 Powerhead 30 l/m, 2.5 m hose whips
566353	ICS 890F4 Powerhead 45 l/m, 30 cm hose whips
566354	ICS 890F4 Powerhead 45 l/m, 2.5 m hose whips
566352	ICS 890F4-FL Powerhead 30 l/m, 30 cm hose whips
566350	ICS 890F4-FL Powerhead 30 l/m, 2.5 m hose whips
566127	ICS 890F4-15 Saw Package 30 l/m with 38 cm Guidebar, ProFORCE-29 chain, 30 cm hose whips, case
566123	ICS 890PG-15 Saw Package with 38 cm Guidebar, PowerGrit-29 chain
531743	ICS FORCE4-25 chain 25 cm
531745	ICS FORCE4-25 Premium L chain 25 cm
531739	ICS FORCE4-25 Premium S chain 25 cm
531747	ICS FORCE4-25 Abrasive chain 25 cm
529829	ICS 890F4 Guidebar 25 cm
525342	ICS FORCE4-29 chain 38 cm
525343	ICS FORCE4-29 Premium L chain 38 cm
531735	ICS FORCE4-29 Premium S chain 38 cm
525344	ICS FORCE4-29 Abrasive chain 38 cm
537764	ICS PowerGrit Chain 38 cm
523080	ICS 890F4 Guidebar 38 cm
531749	ICS FORCE4-34 chain 50 cm
531751	ICS FORCE4-34 Premium L chain 50 cm
531741	ICS FORCE4-34 Premium S chain 50 cm
531753	ICS FORCE4-34 Abrasive chain 50 cm
537765	ICS PowerGrit Chain 50 cm
529767	ICS 890F4 Guidebar 50 cm
525345	ICS FORCE4-40 chain 63 cm
525346	ICS FORCE4-40 Premium L chain 63 cm
531737	ICS FORCE4-40 Premium S chain 63 cm
525347	ICS FORCE4-40 Abrasive chain 63 cm
545017	ICS PowerGrit Chain 63 cm
525320	ICS 890F4 Guidebar 63 cm
565065	ICS 890F4 Drive Sprocket
565066	ICS 890F4-FLUSH Drive Sprocket
70636	890F4 Tensioner Kit
523946	890F4-FL Tensioner Kit

Guidebars, chains and drive sprockets fit 880F4

890 PG- with 63 cm bar & chain





814PRO- with 33 cm bar & chain

Hydraulic Power

814PRO

It may be small but with as much power as the 890 series, the 814PRO is ready for the big jobs. Lighter than other hydraulic power cutters with the ability to cut perfectly square openings as small as 9 cm, the 814PRO is a natural for utility work and other applications where a mix of portability and power are required.



814PRO TECHNICAL SPECIFICATIONS

Weight	6.8 kg with 33 cm bar and chain
Bar Length	33 cm
Motor Speed	8800 rpm
Powerhead Dimensions	36.3 cm Length 28.7 cm Height 23.4 cm Width
Torque	9.5 Nm
Horsepower	8.5 kW
Hydraulic Supply	30 lpm, 172.5 bar
Noise Level	88 dB @ 1 m
Water Supply	Minimum 1.5 bar

* product data shown is rated based on maximum input conditions and efficiency assumptions may vary dependent on power supply.

For Cutting Concrete

814PRO HYDRAULIC POWER CUTTERS AND CONSUMABLES

PART NUMBER	DESCRIPTION
75256	ICS 814PRO Powerhead 30 l/m
71675	ICS 814PRO Saw Package with 33 cm Guidebar & TwinPRO-25 Diamond Chain
74719	ICS TwinPRO-25, 33 cm chain
74042	ICS 814PRO Guidebar 33 cm/25 segments
71385	ICS 814PRO Drive Sprocket
74061	Tensioning Assembly

**For information on
power cutters maintenance, visit:
icsdiamondtools.com/pro-corner**

ICS Customer Service

Trust the experience and product knowledge of the ICS Customer Service team to help you make the most of your investment in ICS products. Proud of their quick response time, our helpful representatives are available by phone or email to answer questions about maintenance and repair, to place orders for products and parts, direct you to a local dealer and make sure you are delighted with your ICS experience.



814PRO- with 33 cm bar & chain



701-A - with 50 cm bar & chain

Pneumatic Power

701-A

Built tough to stand up to everyday use in the harsh environment of concrete cutting. Cut with ease, speed and portability through Reinforced Concrete, Brick, Block, Concrete Pipe, Ductile Iron, Cast Iron, PVC and Natural Stone. The ICS powerful air power cutter is designed to cut through walls, floors and columns in a single pass.



701-A

701-A TECHNICAL SPECIFICATIONS

Weight (without bar and chain)	13 kg
Bar Length	Up to 63 cm
Powerhead Dimensions	58.5 cm x 26.5 cm x 30.5 cm
Air Motor Power	5 kW
Air Supply Requirements (maximum)	6 bar 3.5 m ³ /min
Motor Lubrication	Resin and acid-free SAE 5 W to SAE 10 W oil
Water Pressure Requirements	Minimum: 1.4 bar
Water Flow Requirements	Minimum: 8 lpm
Operating Speed	5,700 rpm (average free running) 4,900 sfm (average free running chain)
Vibration ahv, eq Concrete Cutting ⁽²⁾	Front handle: 5.09 m/s ² (K=0.2 m/s ²) Rear handle: 5.07 m/s ² (K=0.2 m/s ²)
Vibration ahv, eq PowerGrit Cutting ⁽²⁾	Front handle: 4.58 m/s ² (K=0.2 m/s ²) Rear handle: 4.43 m/s ² (K=0.2 m/s ²)
Guaranteed Sound Power Level Lwa (1)	113 dB(A); (Kwa=0.5 dB(A))

(1) Measured in accordance with ANSI S12.51-2012/ISO3741:2010

(2) Measured in accordance with ISO5349-1:2001 and ISO22867:2011

For Cutting Concrete & Pipe

701-A PNEUMATIC POWER CUTTERS AND CONSUMABLES

PART NUMBER	DESCRIPTION
573511	ICS 701-A Powerhead
574173	ICS 701-A F4-15 Pneumatic Saw Package with 38cm guidebar, ProFORCE-29 chain
531743	ICS FORCE4-25 chain 25 cm
531745	ICS FORCE4-25 Premium L chain 25 cm
531739	ICS FORCE4-25 Premium S chain 25 cm
531747	ICS FORCE4-25 Abrasive chain 25 cm
529829	ICS 701-A Guidebar 25 cm
525342	ICS FORCE4-29 chain 38 cm
525343	ICS FORCE4-29 Premium L chain 38 cm
531735	ICS FORCE4-29 Premium S chain 38 cm
525344	ICS FORCE4-29 Abrasive chain 38 cm
537764	ICS PowerGrit Chain 38 cm
523080	ICS 701-A Guidebar 38 cm
531749	ICS FORCE4-34 chain 50 cm
531751	ICS FORCE4-34 Premium L chain 50 cm
531741	ICS FORCE4-34 Premium S chain 50 cm
531753	ICS FORCE4-34 Abrasive chain 50 cm
537765	ICS PowerGrit Chain 50 cm
529767	ICS 701-A Guidebar 50 cm
525345	ICS FORCE4-40 chain 63 cm
525346	ICS FORCE4-40 Premium L chain 63 cm
531737	ICS FORCE4-40 Premium S chain 63 cm
525347	ICS FORCE4-40 Abrasive chain 63 cm
545017	ICS PowerGrit Chain 63 cm
525320	ICS 701-A Guidebar 63 cm
565065	ICS 701-A Drive Sprocket
575013	Airpac, pneumatic saw oiler
575130	Oiler, with hose whip 3/4 x 6ft.
70636	Tensioner Kit



*701-A PG - with 50 cm bar & chain
Pipe Clamp - 30 cm pipe capacity*



ICS Diamond Chain

FORCE4[®] Diamond Chain

From the company that revolutionized concrete power cutters comes a revolution in diamond chains: FORCE4[®]. Designed to be the strongest, longest lasting diamond chains ever made, the FORCE4 series delivers unrivaled performance in professional cutting applications.

FORCE4[®]

Tough general purpose diamond chains that excel in common cutting jobs.

FORCE4[®] Premium L

Delivering longer life in hard aggregate, this is the best choice when faced with the more demanding jobs.

FORCE4[®] Premium S

Speed and strength in one chain. Built to cut fast in medium to hard concrete.

FORCE4[®] Abrasive

A heavy duty diamond chain that excels in the harshest, most abrasive cutting environments.

FORCE3[™] Diamond Chain

The FORCE3[™] Diamond Chains contain patented SealPRO[®] technology which reduces wear and extends chain life. Designed to be used with the full line of ICS petrol-powered cutters, these chains offer the ultimate combination of both versatility and affordability.

Available in 3 formulations to match your specific application and cutting challenges.

FORCE3[™]

Best chain to cut light-medium aggregates and rebar

FORCE3[™] Premium

Best chain to cut harder aggregates and heavier rebar

FORCE3[™] Brick

Optimized for cutting abrasive materials and brick

PowerGrit[®] Utility Diamond Chain

Utilized by public and private water and wastewater departments worldwide, this patented platform exclusively from ICS is designed to cut a variety of materials from ductile iron to plastic pipe. Featuring a brazed layer diamond coating on our FORCE4 platform, this chain makes your job safer, faster and easier.

ICS Diamond Chain

Diamond Chain Technology

Diamond chains are not all created equal, so insist on Diamond Chains from ICS®, the people who invented the technology. As the inventors of Diamond Chain Technology™, ICS is committed to continually improving the quality and versatility as well as the perfect blend of power, precision and efficiency: chains specifically designed for different power cutter types as well as the many different materials you encounter on the job. Choosing the right chain for your needs is essential to getting the best value for your purchase.

FORCE4® Series Diamond Chain

Now with SealPRO Advanced

Diamond chain with SealPRO Advanced technology. Our patented design inserts micro o-rings around every rivet on every link, to seal out the abrasive materials that cause chain stretch. SealPRO Advanced give you up to 15% longer life than concrete cutting chains with SealPRO.

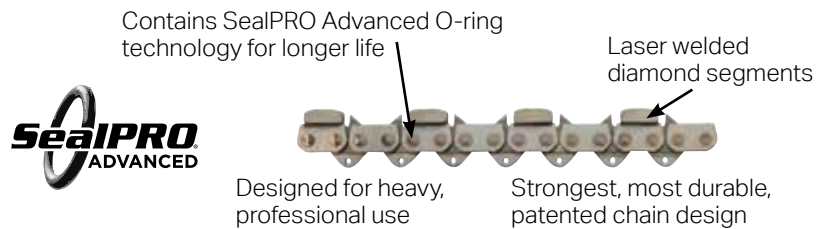

FORCE3™ Series Diamond Chain

Diamond chain with SealPRO technology - our patented design inserts micro o-rings around every rivet on every link, to seal out the abrasive materials that cause chain stretch. Giving you up to 50% more chain life than concrete cutting chains without SealPRO technology.

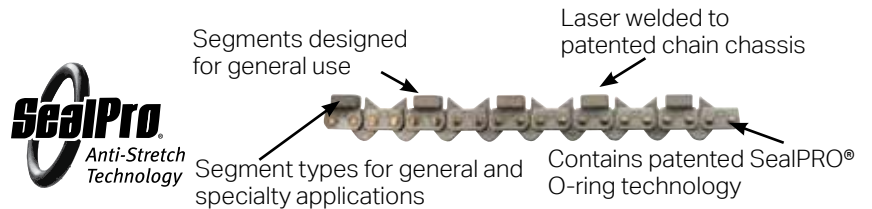

PowerGrit® Utility Chain

The ICS Utility chain power cutter addresses operator safety with its revolutionary grinding technology which eliminates rotational kickback and improves operator positioning when cutting pipe. This patented platform, exclusively from ICS, is designed to cut a variety of materials from ductile iron to plastic pipe with far less excavation.

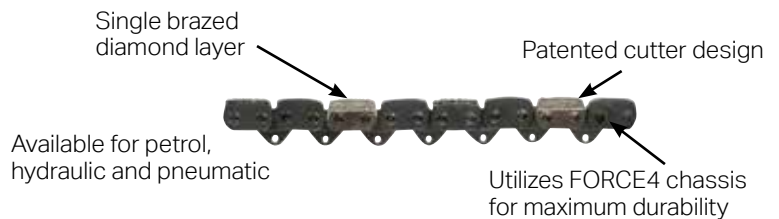

Chain Selection Chart

Chain Applications	Power Cutter	Soft Stone/ Abrasive/Brick	Natural Stone	Medium Concrete/ Light Reinforcement	Hard Concrete/ Heavy Reinforcement	Ductile Iron/Cast Iron/PVC/HDPE
FORCE3™ General Purpose	695ES GC 695XL GC		♦	♦		
FORCE3™ Premium For harder materials	695ES GC 695XL GC		♦	♦	♦	
FORCE3™ Brick Ideal for brick & block	695ES GC 695XL GC	♦				
TwinPro™ General Purpose	814PRO		♦	♦	♦	
FORCE4® General Purpose	890 Series 701-A 695XL F4		♦	♦	♦	
FORCE4® Premium L Longer Cutting life	890 Series 701-A 695XL F4		♦	♦	♦	
FORCE4® Premium S Faster cutting speed	890 Series 701-A 695XL F4			♦	♦	
FORCE4® Abrasive Ideal for brick & block	890 Series 701-A 695XL F4	♦				
PowerGrit® For Utility Pipe	890 Series 701-A 695XL PG 680ES PG					♦



Speedhook

ICS Accessories

ICS® 2-Stroke Oil

Intensive laboratory and field testing have resulted in an oil formula that is cleaner burning, provides better thermal protection and an improved film barrier reducing piston ring wear. Protect your investment with work-proven ICS® 2-stroke Engine Oil.



PART NUMBER	DESCRIPTION
571229	ICS 2 -Stroke Oil, 2%, 100 ml, 6-pack
571230	ICS 2 -Stroke Oil, 2%, 100 ml, 24-pack

50:1 Mix

Replacement Parts

Visit your local dealer or see our website icsdiamondtools.com/customer-service-support/ for a complete listing of available parts.

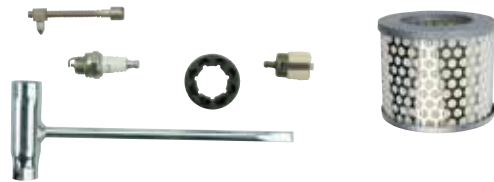

Flow Adapter Valve

Enjoy the convenience and efficiency of powering your ICS® hydraulic power cutter from skid steers, backhoes, and other common construction equipment. Available for both 30 lpm and 45 lpm power cutters.

PART NUMBER	DESCRIPTION
70350	30 lpm Flow adapter valve
71287	45 lpm Flow adapter valve

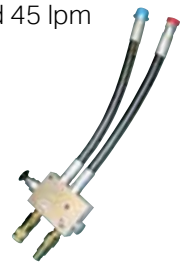

Portable Hydraulic Powerpack

ICS® petrol powered powerpacks are a dependable, self-contained source of hydraulic power that offer superior cooling capacity. The functional, ergonomic design makes them easily transportable to any job site.

P95 18 hp (13.5 kW) Powerpack

Adjustable for 20 lpm or 30 lpm operation.



PART NUMBER	DESCRIPTION
550888	P95 13.5 kW (18 hp) Powerpack

890F4/701-A Pipe Clamp

In addition to the time saving value of PowerGrit® technology, the pipe clamp accessory developed for the underground pipe application brings a whole new level of safety, accuracy and ease of use to the job. With a simple adaptor, you can mount to this clamp and dramatically reduce the effort of handling the power cutter, while providing a solid, stable cutting platform that also improves operator safety and the precision of the cut. Fits pipes up to 30 cm (outside diameter).

PART NUMBER	DESCRIPTION
537640	Pipe Clamp
537634	Axle replacement



FOR 890F4/701-A ONLY

SpeedHook®

SpeedHook® is an ingenious accessory designed to support the weight of ICS® hydraulic power cutters, dramatically reducing operator fatigue and extending chain life.

PART NUMBER	DESCRIPTION
528551	SpeedHook System includes 1 m rail & mounting bracket

Works with:
890F4 Series
701-A Series
880F4 Series
853PRO Series



Portable Water Supply

When water isn't readily available, this corrosion resistant water supply system, with poly tank provides the solution. This system offers the pressure and flow that ICS power cutters require. The High-Flo pump provides 1.8 gpm at 60 psi and comes with alligator clips for 12v battery hookup. Comes with a whip fitted with a standard hose end, ready for any regular hose.

PART NUMBER	DESCRIPTION
551529EU	Portable Water Supply



ICS® Carry Case & Bag

For 890 and 880F4 series.

PART NUMBER 71772



For 680ES & 695XL series

PART NUMBER 582026

Hydraulic Hoses

Quick disconnect, 7,5 m long, 20.68 bar.

PART NUMBER	DESCRIPTION
70466	7,5 m hoses





FAQ

WHEN DO I NEED TO REPLACE A CHAIN?

When the diamond segment has worn down to the welded pad on the chain chassis. Typically a chain will cut 12 - 24 linear meters in 15 cm concrete. On ICS hydraulic power cutter, this range is most often doubled.



Worn FORCE4 chain



Worn PowerGRIT chain

WHAT IS THE PROPER CHAIN TENSION?

All chains have a tendency to stretch when used. Diamond chains stretch more than wood cutting chains because of the abrasive materials they cut. If the chain is too tight, a lot of the cutter's power goes into turning the chain rather than the cut. In extreme over-tightened cases, the power cutter may not be able to turn the chain at all. In addition, damage can occur to the bar nose and premature stretch may occur.

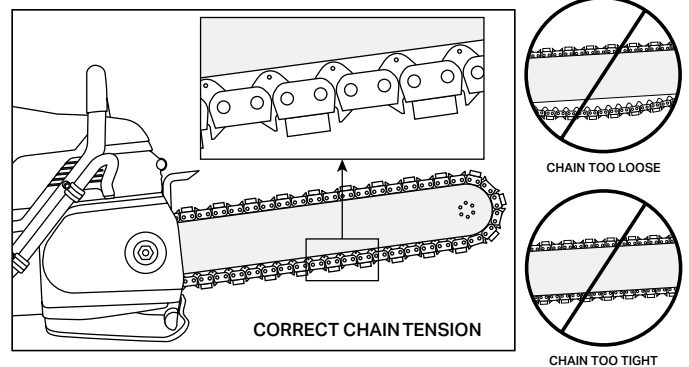

If the chain is too loose, it could come off the bar, or it will allow the drive sprocket to spin without turning the chain, which can chew up drive links. When a chain stretches to a point where the drive links are hanging approximately 12 mm to 18 mm below the bar, it is time to tension the chain.

See ICS training videos for power cutter setup

REGARDING CUTTING PIPES THAT ARE FULL OF WATER...CAN I CUT INTO THE PIPE AND RELY ON THE WATER INSIDE TO COOL THE CHAINS (DIAMOND AND POWERGRIT)?

The cooling and lubrication for the chains needs to be delivered thru the power cutter/guidebar and therefore you must have a minimum of 1.5 gpm going through the power cutter.

CAN I POUR WATER ON THE CHAIN IF I DO NOT HAVE A WATER SOURCE DELIVERABLE THROUGH A HOSE?

The guidebar is designed with water channels that distribute water to the chain to lubricate and cool and also flush the chain of debris. Pouring water on the chain is not only dangerous, it will drastically increase chain stretch and reduce chain and bar life.

FAQ

TO CUT CONCRETE, BRICK, BLOCK OR EVEN DUCTILE IRON PIPE. IS THE WATER REQUIREMENT DIFFERENT FOR THESE?

The water requirement for using the ICS Diamond Chain or the ICS Powergrit Chain to cut any of the above is the same however if you can use more water, especially when cutting abrasive things like brick and block, more water helps to add to longer chain and guidebar life because it is flushing the abrasive materials away.

WHAT IF IT IS FREEZING OR BELOW FREEZING AND I CANNOT GET WATER TO MY POWER CUTTER BECAUSE THE HOSE OR POWER CUTTER IS FROZEN AND PLUGGED UP...CAN I MAKE MY CUT?

Water as previously stated is crucial to the performance of these chains. There are several different anti-freeze products you can use in this situation. Contact your regulatory agency for specific details.

WHEN DO I NEED TO REPLACE MY DRIVE SPROCKET?

Drive sprockets need to be replaced when the groove has worn 50% of the way through the top of the sprocket tooth. A rule of thumb for ICS petrol power cutters is every 2-4 chains and for ICS hydraulic power cutters, every 7-9 chains (depending on chain chassis).

HYDRAULIC



NEW → REPLACE

PETROL



NEW → REPLACE

CAN A DIAMOND CHAIN CUT REBAR?

Yes, number (12 or 16 mm) bar is not a problem. Anything over 25mm is difficult. Large amounts of rebar will reduce chain life. Caution: rebar must be surrounded by concrete or aggregate material.

WILL POWERGRIT CUT STEEL?

PowerGrit utility chain is designed to cut ductile iron pipe, cast iron pipe, HDPE and PVC.

WHAT IS THE MIXTURE RATIO OF FUEL TO OIL

Consult your operator manual for the proper fuel to oil mix recommendation.

WHAT STEPS SHOULD I TAKE DAILY TO MAINTAIN MY POWER CUTTER?

After each use, rinse the power cutter, bar and chain with water. Inspect all fasteners, sprocket, starter rope and air filter for wear. Oil the guidebar, diamond chain and bar nose sprocket and grease the chain tensioner.

For more information and to view instructional videos, please visit: icsdiamondtools.com.









Diamond Tools and Equipment

**ICS, Blount Europe SA
Rue Emile Francqui 5
1435 Mont-Saint-Guibert, Belgium
+32 10 301 251**

icsdiamondtools.com